

Features

- Solenoid Operated Directional Control Valves
- Multiple Spool Configurations
- Multiple voltages and connector styles including conduit connection wiring box
- Coil/Spool orientation mirror image of I series
- Buna NBR seals standard

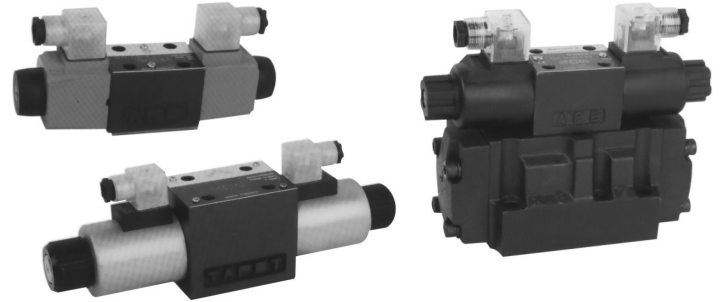

Ordering Details

V	Valve			
S	Sub-plate mount			
D	Directional Control			
6-	Size (mounting Pattern):	Code	Size	
		6	NG6 (D03)	
		10	NG10 (D05)	
		16	NG16 (D07)	
		25	NG25 (D08)	
32	NG32 (D10)			
C-	Spool Configuration:	3 Position Transition shown (dotted)		
		O	T	
		C	V	
		L	D	
		M	N	
24	Solenoid Voltage:	Code	Voltage	
		12	12VDC	
		24	24VDC	
		110	110VAC	
		220	220VAC	
DL-	Electrical Connector Style:	Code	Type	
		DL	Din 46350 Form A w/lights	
		CL	Conduit Wiring Box w/lights	
		FLY	Wiring Box w/flying leads	
Options:	Pilot Valve Supply For Size 16, 25, 32 Two Stage Valves		Stroke Adjustment For Size 16, 25, 32 Two Stage Valves	
	Code	Supply	Code	Location
	II	Internal pilot, Internal drain (Standard)	AB	Both A and B side
	EI	External pilot, Internal drain	A	A side
	IE	Internal pilot, External drain	B	B side
	EE	External pilot, External drain		
	2 Position Solenoid on "b" Side		2 Position Solenoid on "a" Side	
	BP	AP	BO	AO
	BC	AC	With Detent	
	CD	OD		
A	Series: American NFPA Standard (energize "a" provides flow P to A)			

Example Part Number: VSD6-C-24DL-A

Technical Specifications:

Mounting Size	ISO	NG6	NG10	NG16	NG25
	Cetop	D03	D05	D07	D08
Maximum Flow Rate, LPM (GPM)	At max. pressure	60 (16)	120 (31)	300 (79)	500 (131)
	*Spool Y, T, H	-	-	235 (82)	131
	*Spool M	-	-	165 (43)	-
	*Spool D, N, C	-	-	145 (38)	-
	*Spool L	-	-	135 (36)	-

* Max. Flow above 160bar/2320PSI

Maximum Working Pressure (A, B & P port)	Bar (psi)	350 (5075)	315 (4500)	315 (4500)	315 (4500)	
Maximum Working Pressure (T Port)	Bar (psi)	210 (3045)	160 (2320)	-	-	
	External Drain (AC and DC)	Bar (psi)	-	-	250 (3625)	250 (3625)
	Internal Drain (DC)	Bar (psi)	-	-	160 (2320)	160 (2320)
	Internal Drain (AC)	Bar (psi)	-	-	100 (1450)	100 (1450)
Maximum Working Pressure (Y port)	External Pilot (DC)	Bar (psi)	-	-	160 (2320)	160 (2320)
	External Pilot (AC)	Bar (psi)	-	-	100 (1450)	100 (1450)

Solenoid Power Consumption , DC	Watts	30	38	30	30
Solenoid Power Draw, AC	Watts	27.5	40	27.5	27.5
Maximum Operating Temperature	-30 to +80°C (-22 to +176°F)				

Weight	Single Solenoid	AC	Kg (lbs)	1.5 (3.3)	4.2 (9.2)	Consult Factory	Consult Factory
		DC	Kg (lbs)	1.7 (4.7)	5.0 (11.0)	Consult Factory	Consult Factory
	Double Solenoid	AC	Kg (lbs)	2.1 (4.6)	5.7 (12.5)	Consult Factory	Consult Factory
		DC	Kg (lbs)	2.3 (5.0)	6.5 (14.3)	Consult Factory	Consult Factory

Mounting Pattern Dimensions (mm):

NG6 (D03)

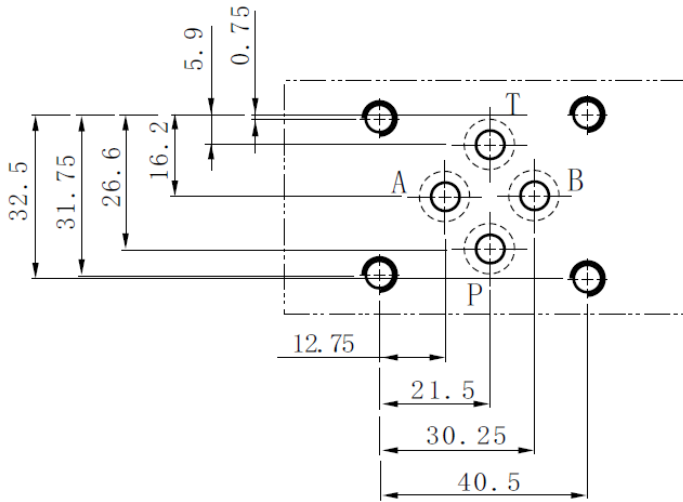

NG10 (D05)

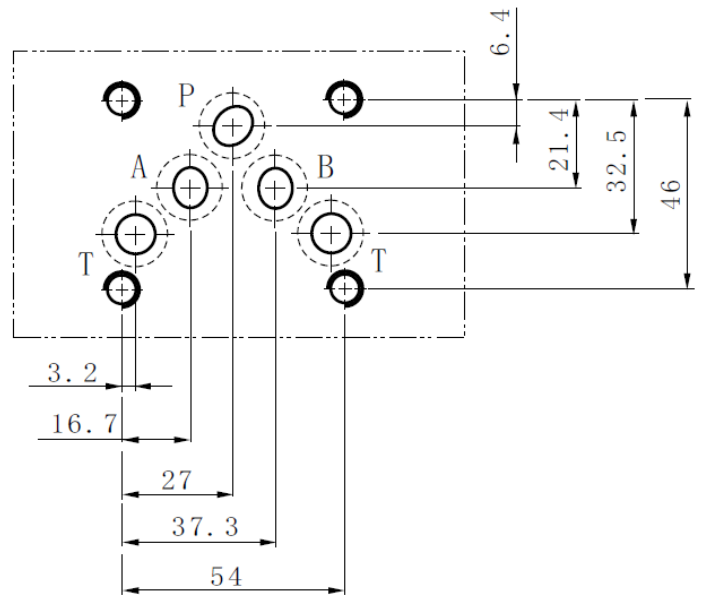

NG16 (D07)

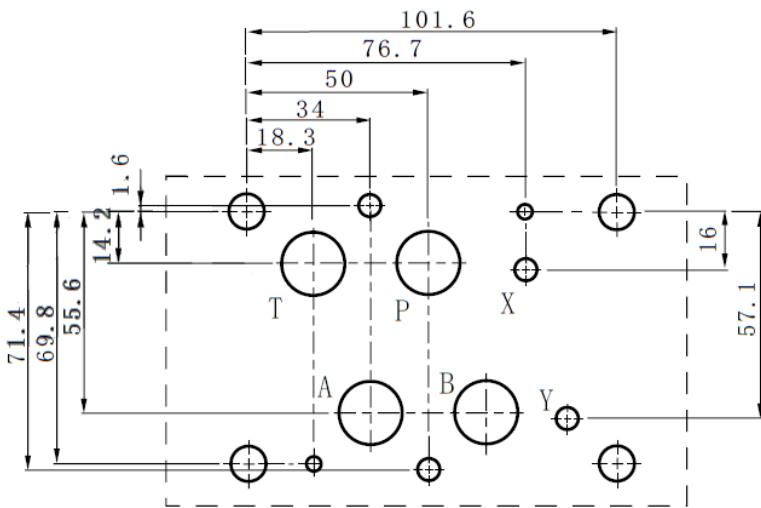

NG25 (D08)

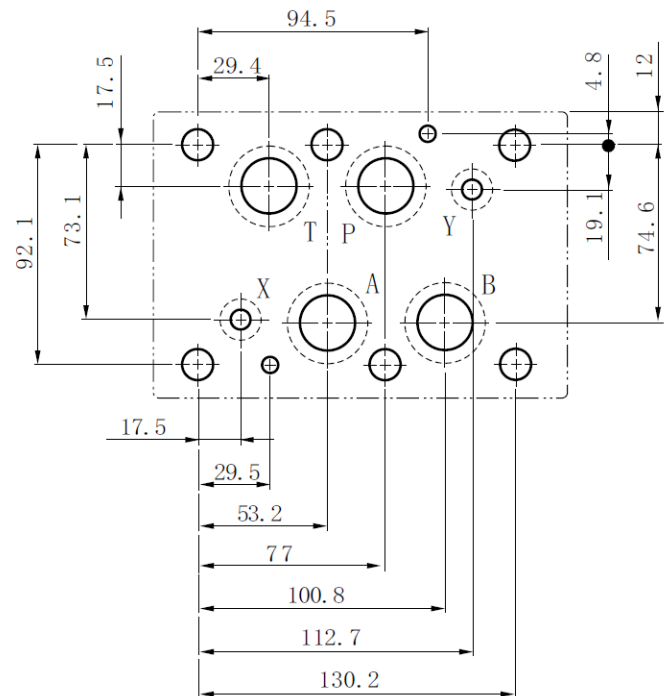

Dimensions (mm):

VSD6...DC coil

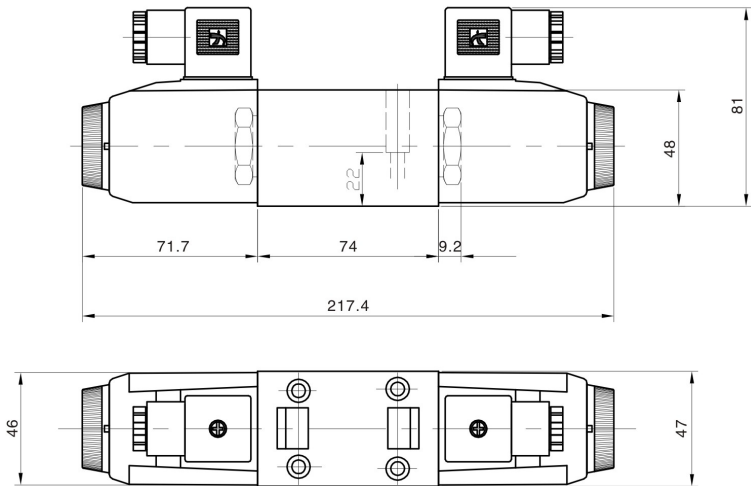

VSD6...AC Coil

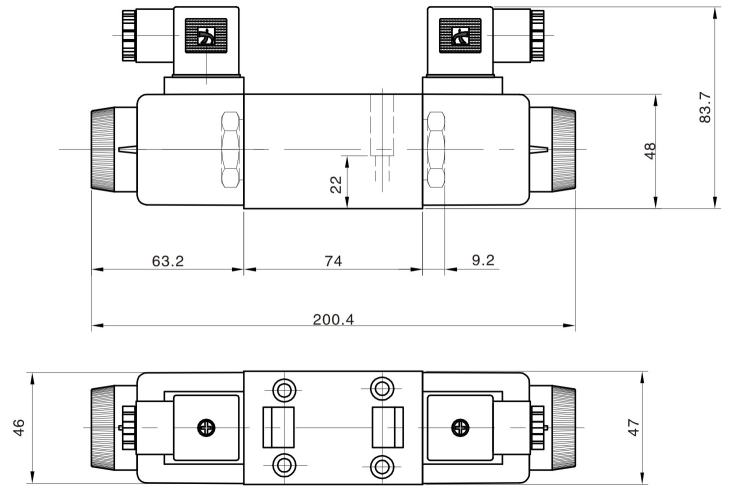

VSD10...DC coil

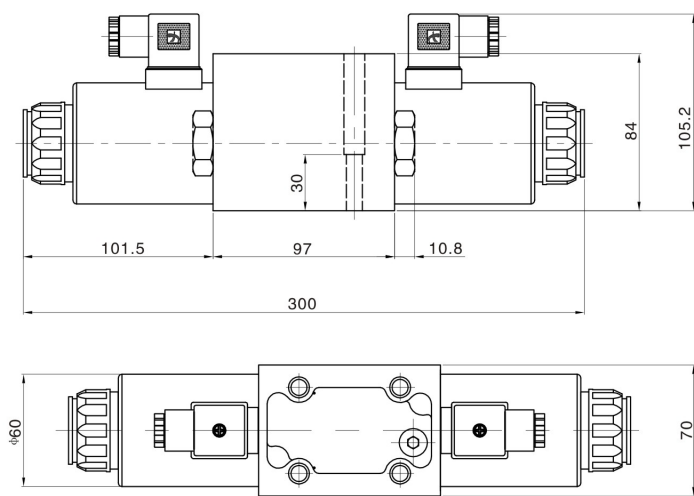

VSD10...AC Coil

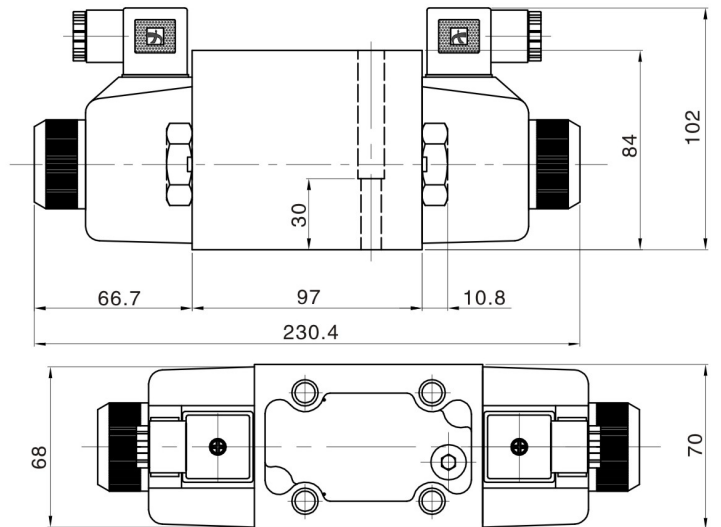

VSD16...DL and CL coil

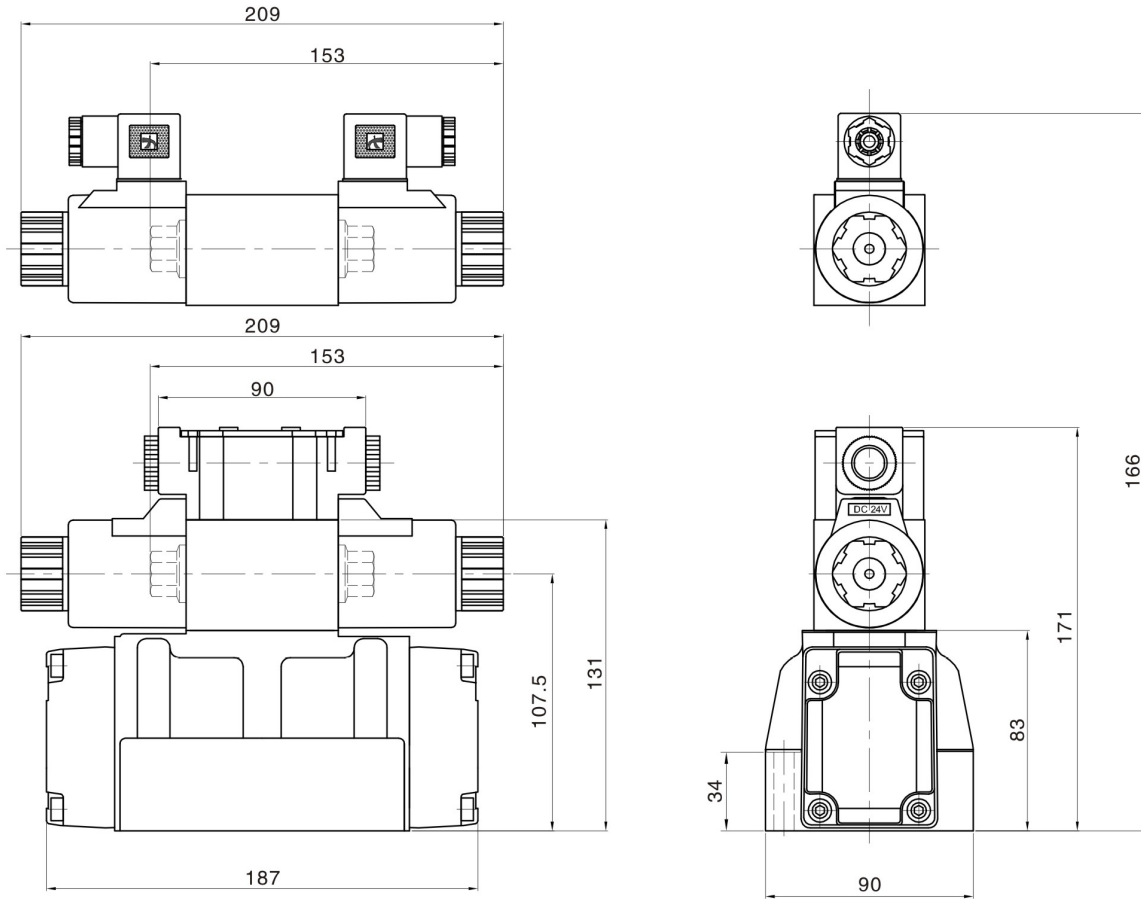

VSD25...DL and CL coil

